

Standing Desk Cable Management Spine Installation Guide

CM01B / CM01S

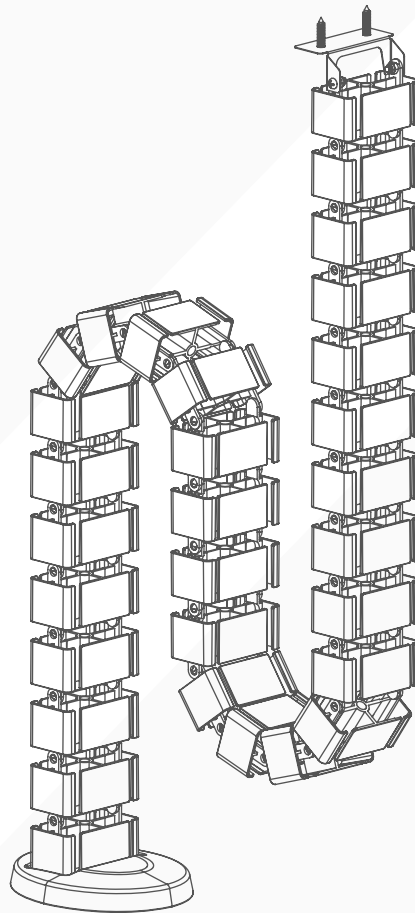

SAPIEN

mysapien.co.uk

Before you start

Please read the entire instruction manual before you start installation and assembly. If you have any questions regarding any of the instructions or warnings, please contact Sapien for assistance.

- **Cable Management Spine** must be attached as specified in the assembly instructions provided. Improper installation may result in damage or serious personal injury.
- Safety gear and specified tools must be used.
- Make sure that the supporting surface will safely support the combined weight of the equipment and all cables inserted.
- Use the mounting screws provided and **DO NOT OVER TIGHTEN** mounting screws.
- This product contains small items that could be a choking hazard if swallowed. Keep these items away from children.
- This product is intended for indoor use only. Using this product outdoors could lead to product failure and personal injury.

IMPORTANT: Check all parts are present according to the component checklist prior to installation. If any parts are missing or faulty, please contact us and we will be happy to help.

MAINTENANCE: Check the cable tension within the spine on a regular basis to ensure safety and prevent damage to any connected equipment.

Checklist

Please Note: Mounting Plate **B** comes pre installed onto the Spine Sections **C**

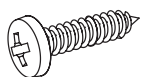

2x 20mm Screws

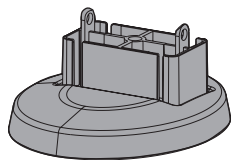

A 1x Base

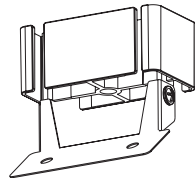

B 1x Mounting Plate

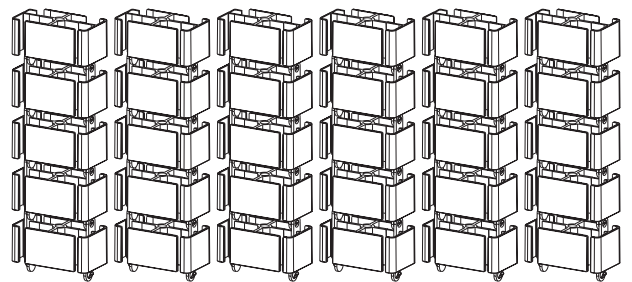

C 30x Spine Sections

Packaged in 3 rows of 10

Additional Tools Required



Pencil

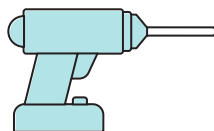

Drill

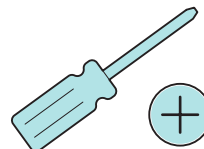

Phillips Screwdriver

Positioning and Marking Out

- 1 Lay desk top onto flat surface so that the under side is accessible and mark out with a pencil where you want the cable management spine to hang from.
- 2 Once marked, use a 4mm drill bit and drill 2x holes with a maximum depth of 10mm. (Use depth gauge if needed)

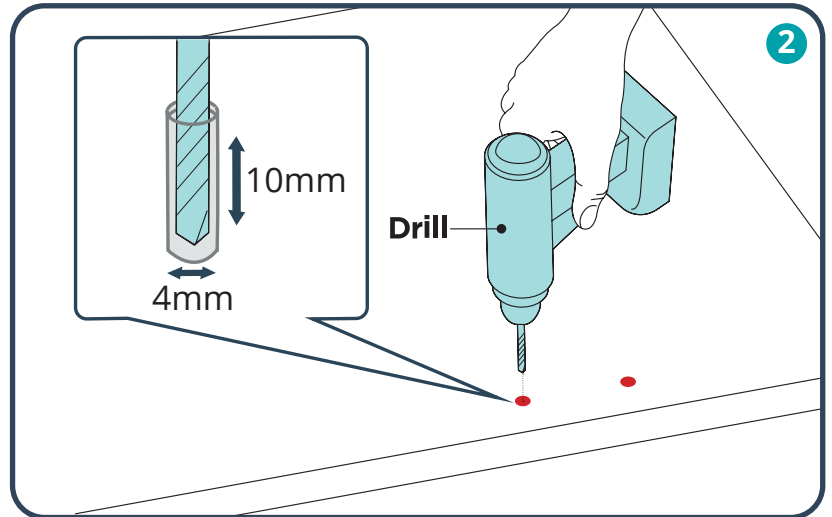
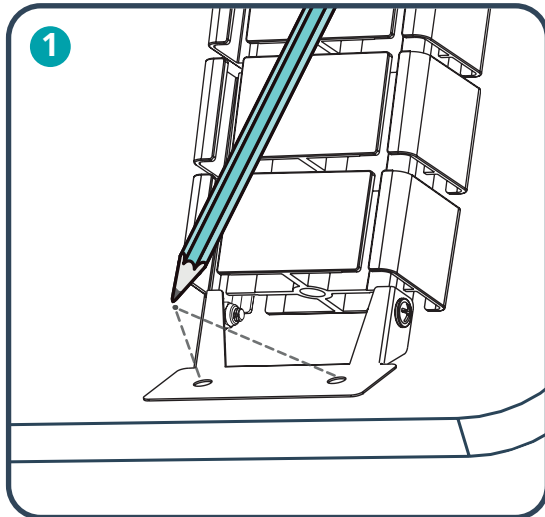

Attaching the Spine to the Desktop

IMPORTANT NOTICE

The following steps require the desk to be turned over onto its feet which will require **two people** to complete safely. Please ensure that this is done in a safe space clear of any obstructions to avoid injury to yourself and others.

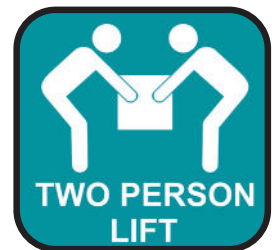

- 1 Take the **Spine Sections C** with the **Mounting Plate B** and secure this to the two holes (drilled in the previous section) using a Phillips screwdriver with the **2x Screws** supplied.
- 2 Now turn the desk over onto its feet (2 people are required for this part)

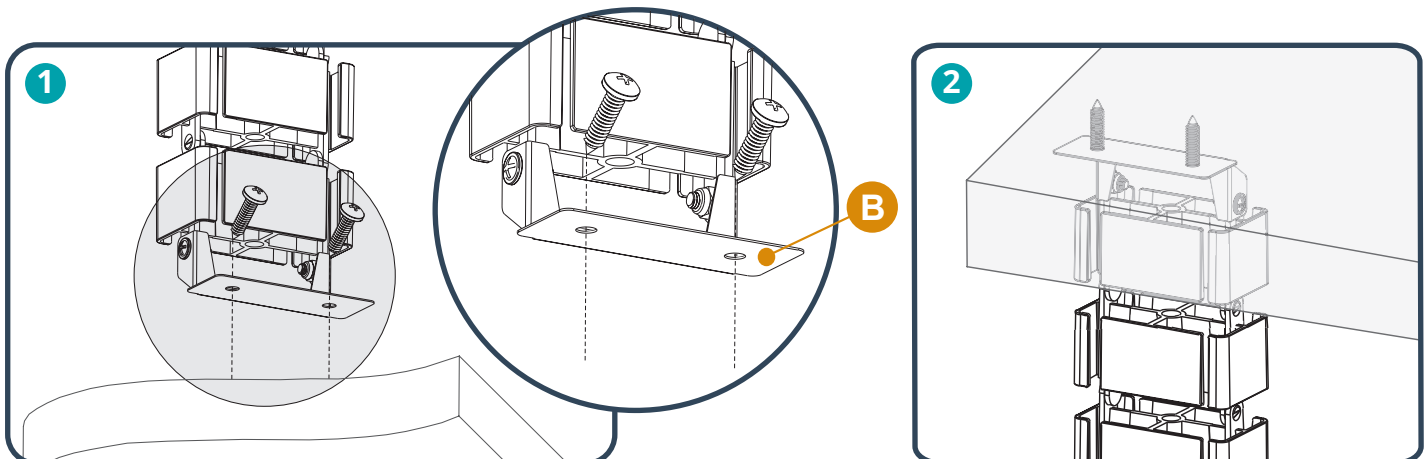

Attaching the Remaining Spine Sections

- 1 Clip on the remaining **Spine Sections C** by lining one of the links up (link hole over the knuckle) and then with gentle pressure twist to snap and secure the 2nd link into place. To remove a spine section grab the section you want to remove and using gentle pressure twist the section to free the link hole from the knuckle.
- 2 Establish the length of **Cable Management Spine** you require and then attach the **Base A** using the same principle as in part 1 above.
(As the desk is height adjustable it will require all of the **Spine Sections C**)

Pro Tip: For ease of installation, raise the desk to it's maximum height.

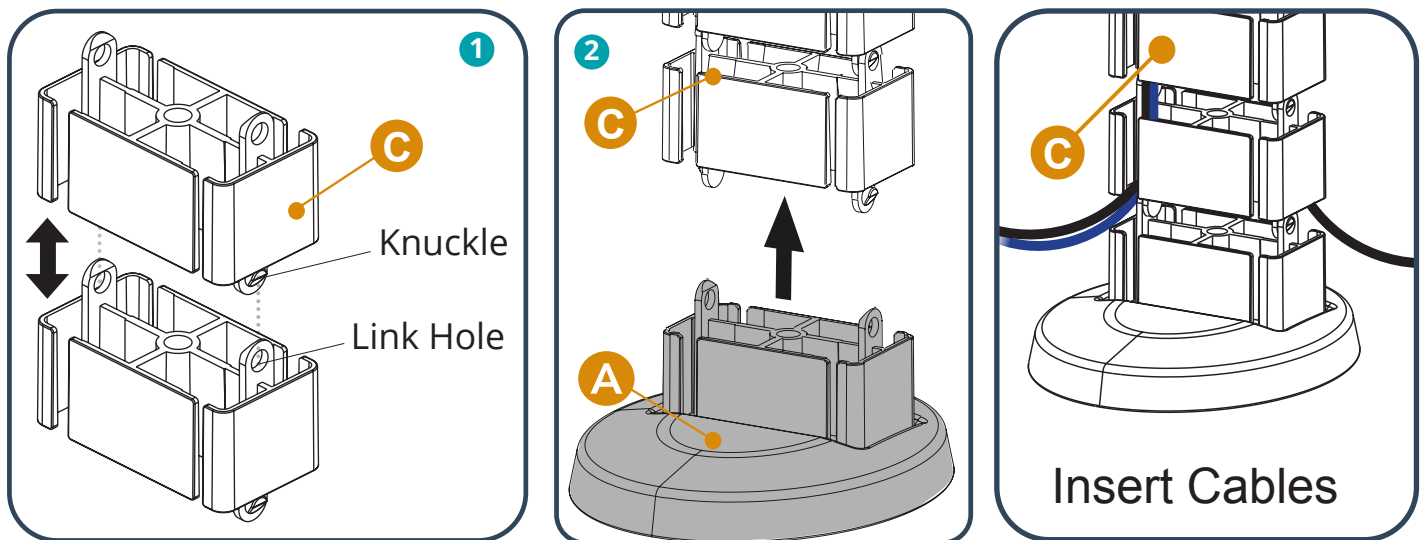

There are 4 compartments within the **Cable Management Spine**, 2 of the compartments have a wider slot (5.5mm) to add thicker cables - see diagram below. Starting from the top (leaving plenty of slack to attach cables to devices) push the cable into each **Spine Sections C** by depressing the central flap with your thumb and pushing the cable into the compartment. Repeat this process until you reach the bottom of the **Cable Management Spine**.

For safety, prior to connecting any cables to power, check that none are stretched, twisted or trapped.

